

© Tolerances: I30/DIN 16901

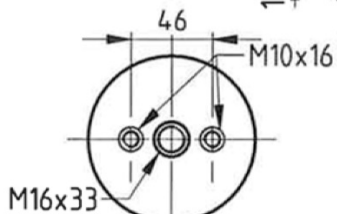

TOP View

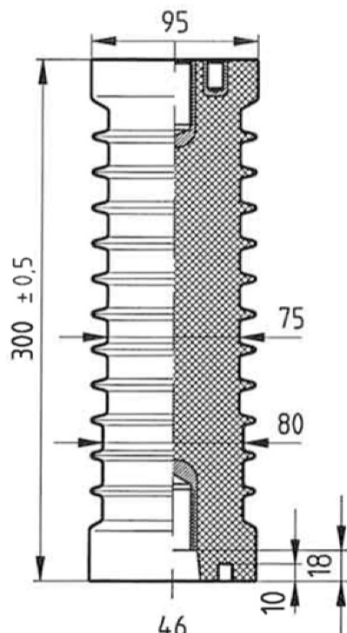
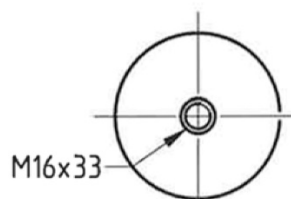

Design 2

Design 1
With Potential connection
DIN 48136
IEC 273

Tests corresponding IEC 60660 (VDE 0441/part 3)

Color = RAL 8016

Type	B 30N-750	JO7,5-170	170 kV	70 kV	> 7,5 kN	434 mm	11	3,2 kg
	Designation corresponding DIN 48136	Designation corresponding IEC 60273	Lightning impulse withstand voltage	Power frequency withstand voltage, dry	Failing load bending	Creepage distance	Numbers of ribs	Weight

Index	Modification / Complement	Date	Name	Appr	Index	Modification / Complement	Date	Name	Appr
a	Artikcle nr	12.02.96	JB		d				
b	Bending 7,5 kN	22.01.97			e				
c	Test & tolerances	27.01.05			f				

Date	Name	Customer	Article	Drawing N° : M0040-0
Prepared 27.09.95	JB	BINAME	B233-1 (design 1)	BINAME INSULATORS
Approved 12.7.06		Material : Epoxy	B235-1 (design 2)	
Scale : 1:1	Type :			BINAME INSULATORS Robert Dansaertlaan 250 1702 Groot-Bijgaarden Belgium
General tolerances DIN 16901 130	Casting epoxy resin indoor post insulator JO7,5-170 B233-1 – B235-1			